

CITY OF NAPOLEON GENERAL PERMIT APPLICATION

THIS APPLICATION IS FOR RESIDENTAL CONSTRUCTION INCLUDING BUILDING, ELECTRICAL,
PLUMBING, MECHANICAL & REMODELING

OK
P.KH-11-0066

DATE 7-18-11 JOB LOCATION 204 Rohrs Ave Napoleon
 OWNER Leonard & Jayne Kolbe TELEPHONE # 599-3488
 OWNER ADDRESS 204 Rohrs Ave Napoleon
 CONTRACTOR Jack Retcher CELL PHONE # _____
 DESCRIPTION OF WORK TO BE PERFORMED 2 car garage

ESTIMATED COMPLETION DATE 12-31-11 ESTIMATED COST 2,000.00

Affected Floor Area (AFA): In existing structures, it is the area affected by the improvement, i.e. a new wall dividing a room (the AFA would be only the room and not all the rooms).

DESCRIPTION	FEE	TOTAL COST
BUILDING:		
<i>Decks</i>	\$25.00	\$
<i>Addition & Alterations</i> Square foot in (AFA) x \$0.05 = \$	+	\$25.00 = \$
Garage and Shed over 200 SF (Detached)	\$25.00	\$ <u>25.00</u>
<i>Siding and/or Roofing</i>	\$25.00	\$
<i>Windows/Doors</i>	\$25.00	\$
ELECTRICAL:		
<i>Electrical</i> Circuits in (AFA) x \$3.00/Circuit = \$	+	\$25.00 = \$
Electrical Service Upgrade	\$25.00	\$
MECHANICAL:		
Water Heater	\$25.00	\$
Furnace and/or AC Replacement	\$25.00	\$
PLUMBING:		
<i>Plumbing</i> Traps in (AFA) x \$3.00/Trap = \$	+	\$25.00 = \$
TOTAL plus Ohio Board of Building Standards Fee 1%		\$ <u>.25</u>

TOTAL FEE: \$ 25.25

I FULLY UNDERSTAND THAT NO EXCAVATION, CONSTRUCTION OR STRUCTURAL ALTERATION, ELECTRICAL OR MECHANICAL INSTALLATION OR ALTERATION OF ANY BUILDING STRUCTURE, SIGN, OR PART THEREOF AND NO USE OF THE ABOVE SHALL BE UNDERTAKEN OR PERFORMED UNTIL THE PERMIT APPLIED FOR HEREIN HAS BEEN APPROVED AND ISSUED BY THE CITY OF NAPOLEON BUILDING/ZONING DEPARTMENT.

I hereby certify that I am the Owner of the named property, or that the proposed work is authorized by the Owner of record and that I have been authorized by the Owner to make this application as his/her authorized agent and I agree to conform to all applicable laws of the jurisdiction. In addition, if a permit for Work described in this application is issued, I certify that the code official or the code official's authorized representative shall have the authority to enter areas covered by such permit at any reasonable hour to enforce the provisions of the code(s) applicable to such permit.

I HEREBY ACKNOWLEDGE THAT I HAVE READ AND FULLY UNDERSTAND THE ABOVE LISTED INSTRUCTIONS.

SIGNATURE OF APPLICANT: Jayne E Kolbe DATE: 7-18-11

PRINT NAME: Jayne E Kolbe

BATCH # 24752 CHECK # 10017 DATE 7-18-11

P.KH-11-0066

204 Rohrs ST

Third ST

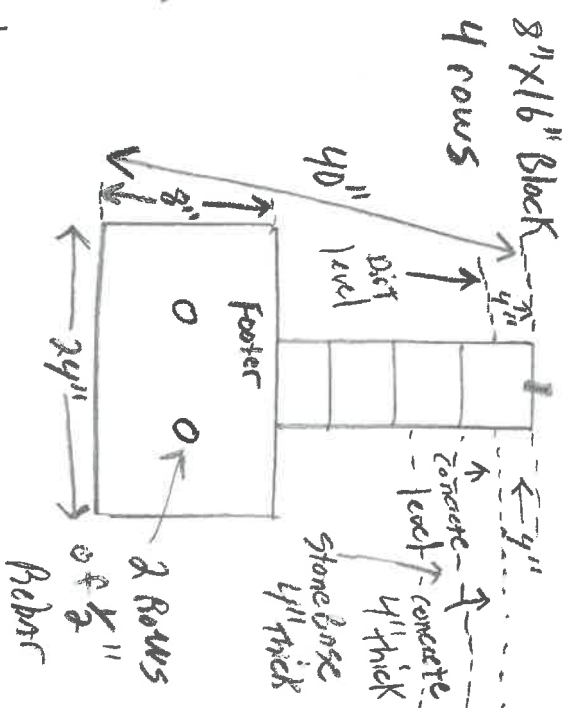
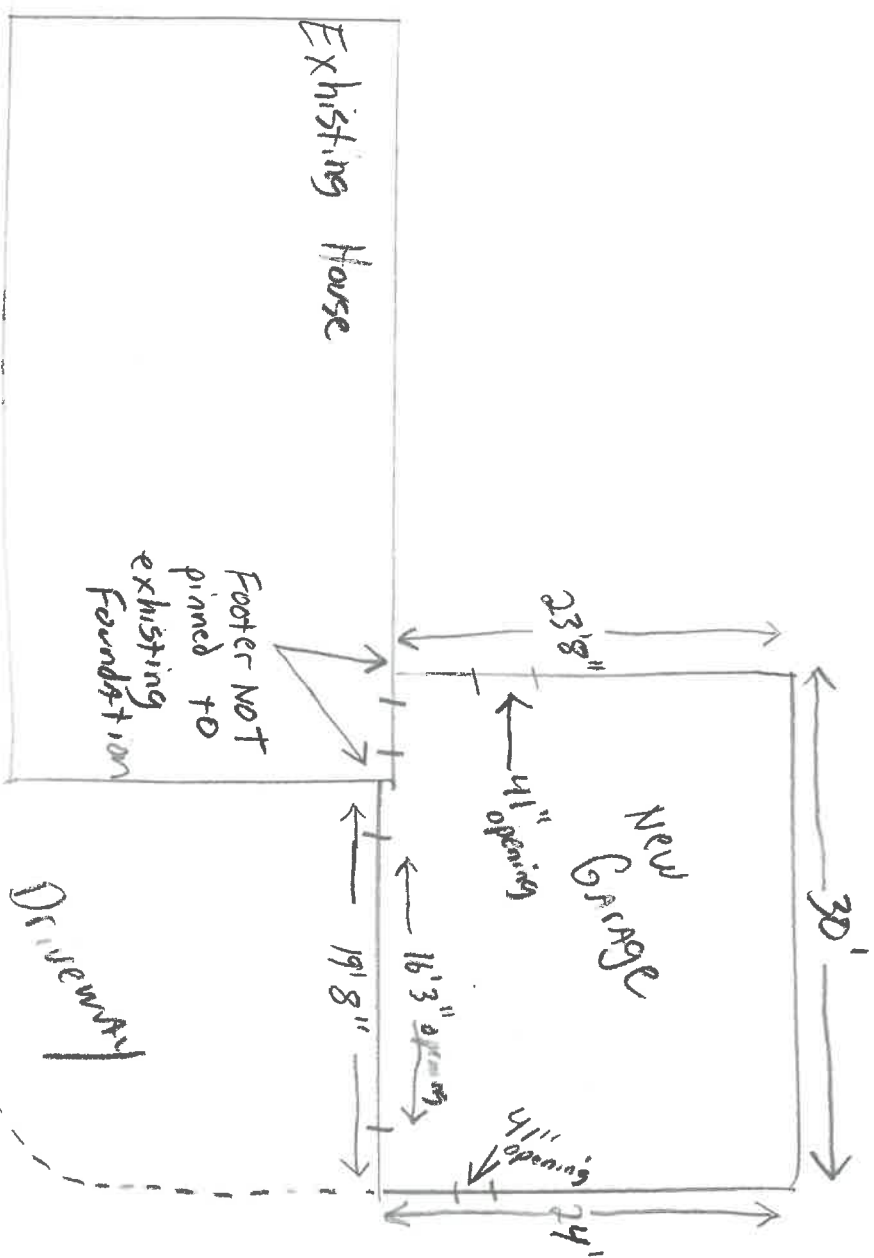

SCANNED
1-9-12

installed and Drawn By -

J.A. Hillis excavating LLC.

Rohrs ST

4-1/2"

84-0

Existing

3'-6" Entrance Door
Add 3" For R.O.
(41")

30-0

16-0 WIDE
OVER head Door
Add 3" For
Rough Opening

3'-0" + 6" Entrance Door
Add 3" For R.O.
(41")

5'-0" + 2" OVER

PROPERTY LINE

80-0

4'-4"

4'-4"